

Digital OB vans Elvia

- 15-cam
- 8-cam
- 6-cam
- 4-cam
- DSNG
- ENG



Digital 15 camera OB van

Application summary:

- Large-sized comfortable unit, based on standard trailer chassis
- Ideal for multi-camera general-purpose productions as live sports, entertainment, etc.



- 15 camera chains
- SD 625/50 scanning
- SDI for main signal path, PAL or analog components for auxiliary purposes

Digital 15 camera OB van

Plan layout:

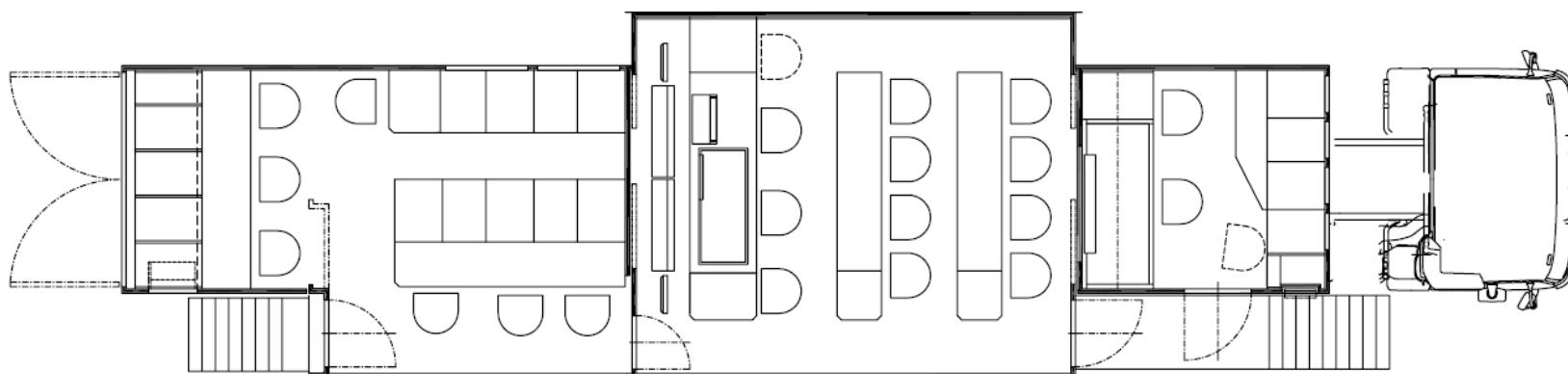

Rear cable area

Vision area

Production area

Audio area

Digital 15 camera OB van

Rear connections
and cable area:

- Motorized cable drums
- Triaxial camera cables, multi-pairs audio cable, main cable
- Terminating panels for external connections
- Air-condition area

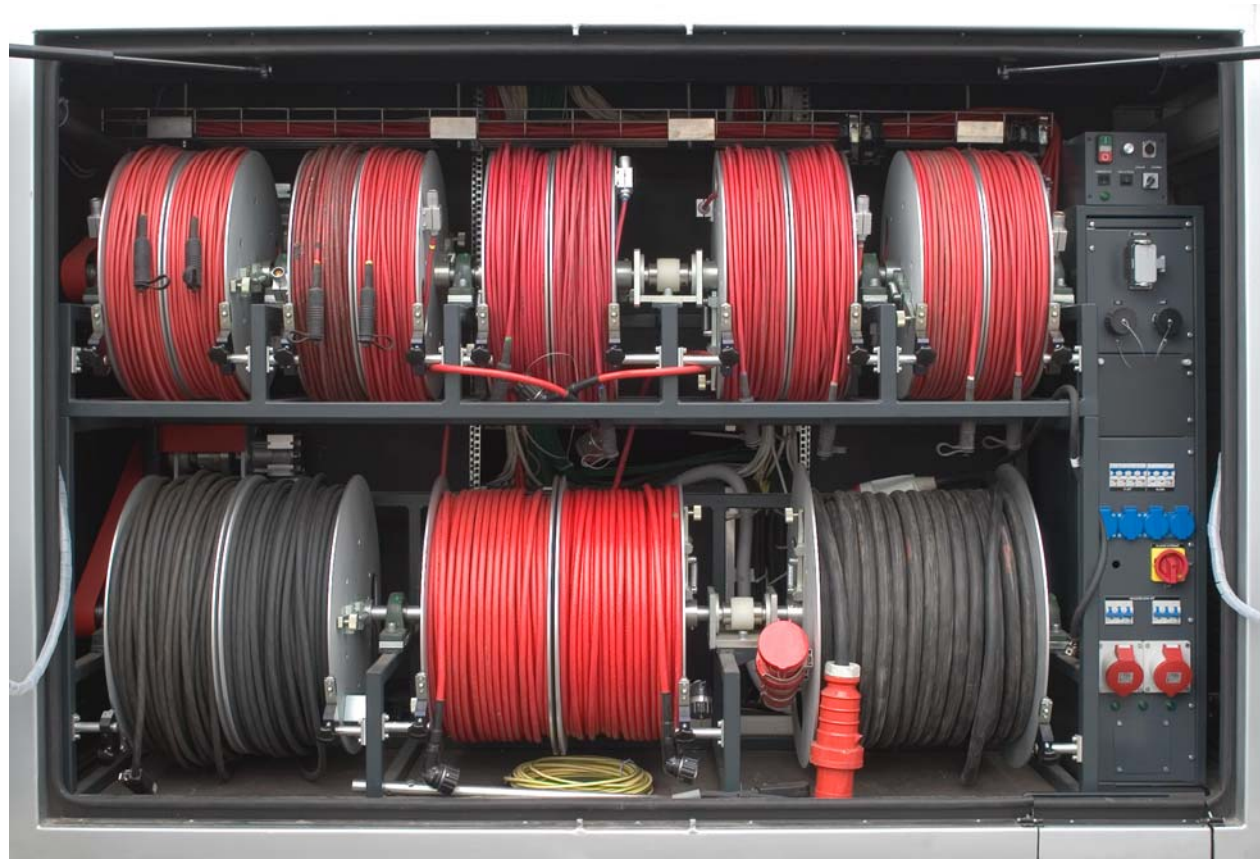

Digital 15 camera OB van

Production area:

- Comfortable large production room
- Big configurable LCD monitor wall
- Movable side walls for expanding space



- Production desk with video switcher, DME and character generator control
- Another 2 rows of desks for slo-mo control and assistance
- Intercom panels and phone sets

Digital 15 camera OB van

Audio area:

- 24-input audio mixer
- Local audio sources – DAT, MD, CD and HD recorder, instant replay
- Audio processor, limiters/expanders, digital telephone hybrid
- Dual channel audio matrix 24x8, extensive patch panel
- Large LCD display

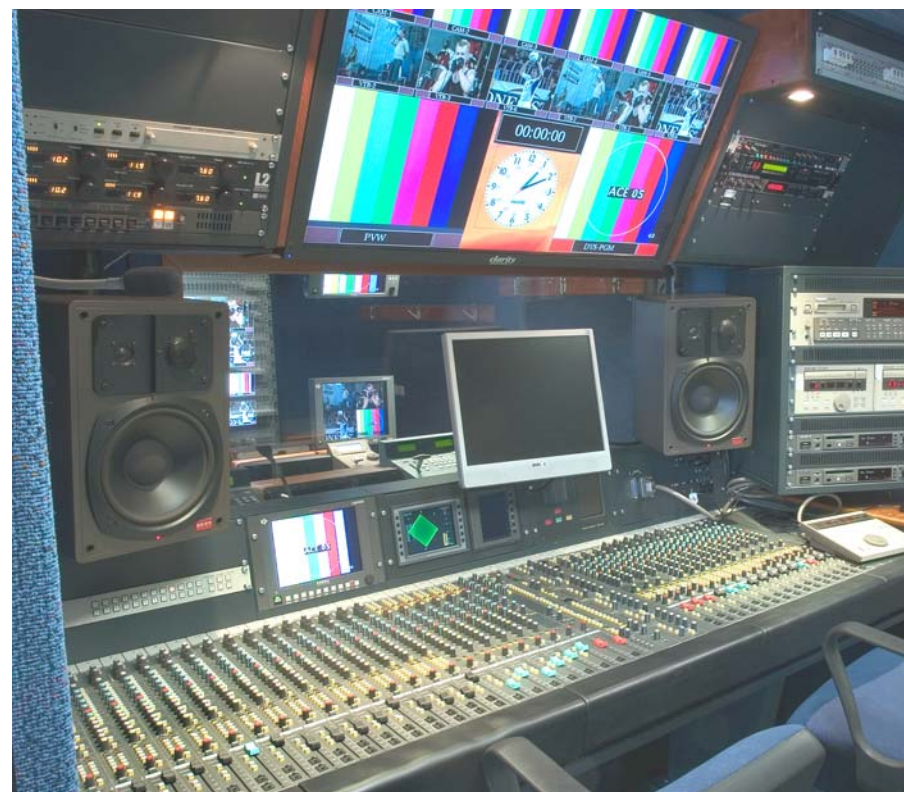

Digital 15 camera OB van

Vision and VTR area:

- 15 camera control CPU and MSU
- 9", 14" and large LCD monitors
- Dual SPG, WFM, power switchboard

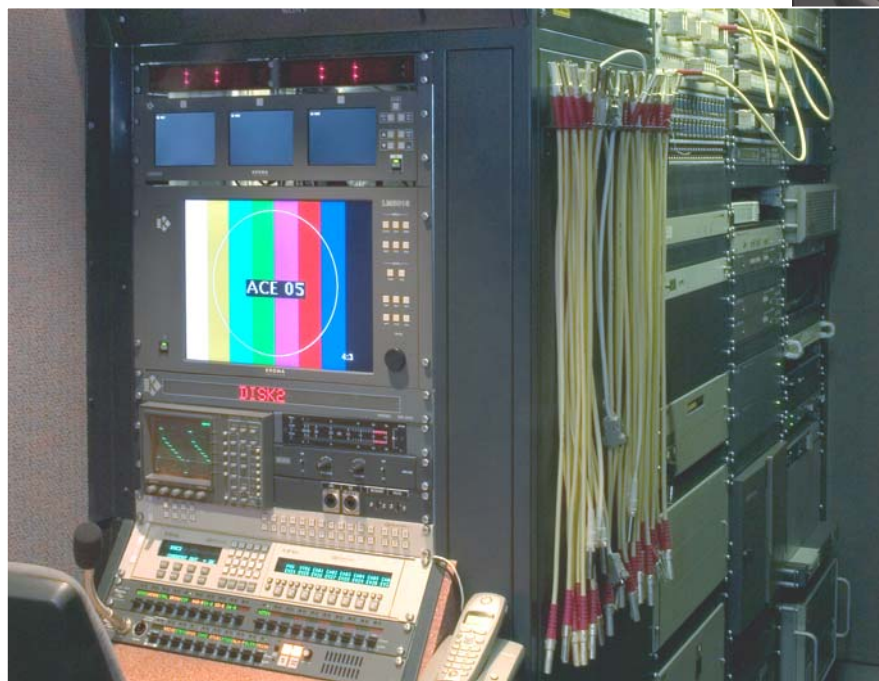

- 6 Digital Betacam/DVCAM/XDCAM VTRs, 4 channel digital disk recorder
- Slo-mo controllers
- Digital video matrix 128x128
- A/D and D/A convertors

Digital 8-10 camera OB van

Application summary:

- Large-sized unit, based on a MB Atego 2524 chassis
- Ideal for general-purpose productions as live sports, entertainment, etc.
- Featured equipment includes Sony BVP-950 cameras, Digital Betacam VTRs, the DVS-7200 switcher processor with DME-3000 digital multi-effects. The sound and communications facilities include a range of Sennheisser microphones, an analogue audio mixer Studer; audio sources, telephone hybrid and talkback facilities



Digital 8-10 camera OB van

Plan layout:

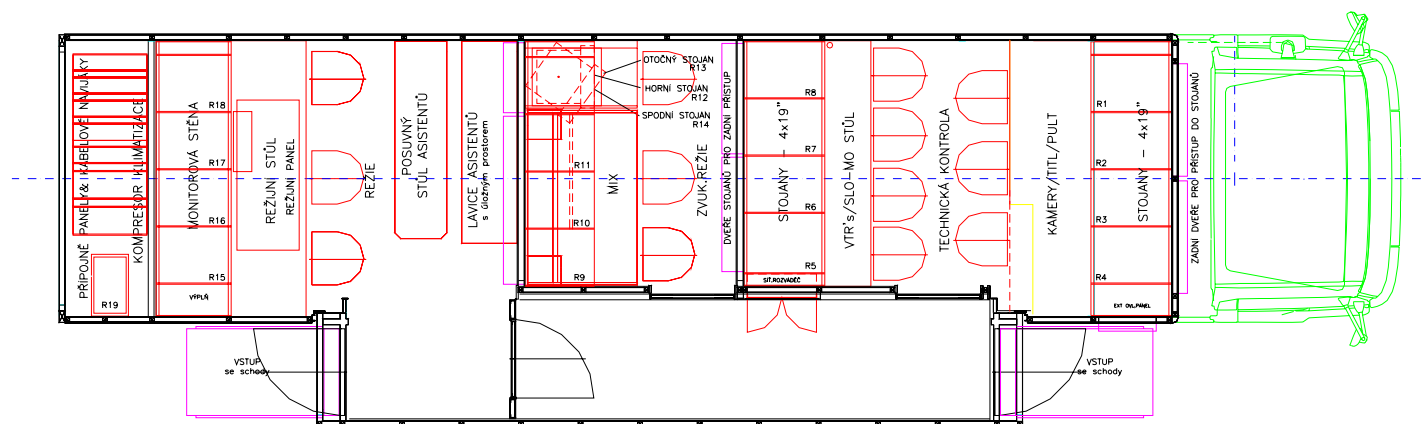

Rear cable area

Production area

Audio area

Vision area

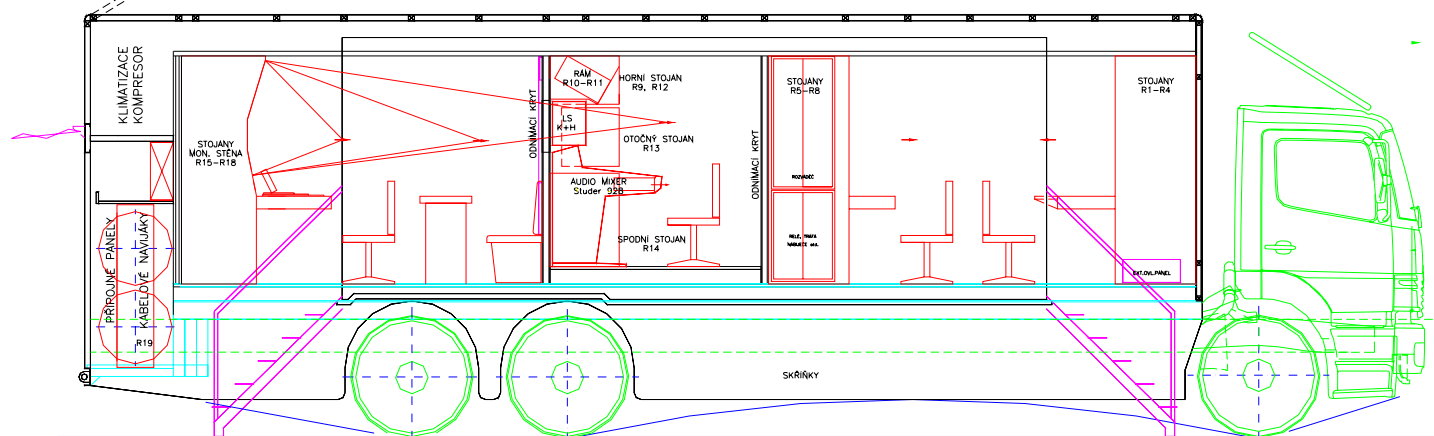

Digital 8-10 camera OB van

Rear connections and cable area:

- Motorized cable drums
- Triaxial camera cables, multi-pairs audio cable, main cable
- Terminating panels for external connections
- Air-condition area

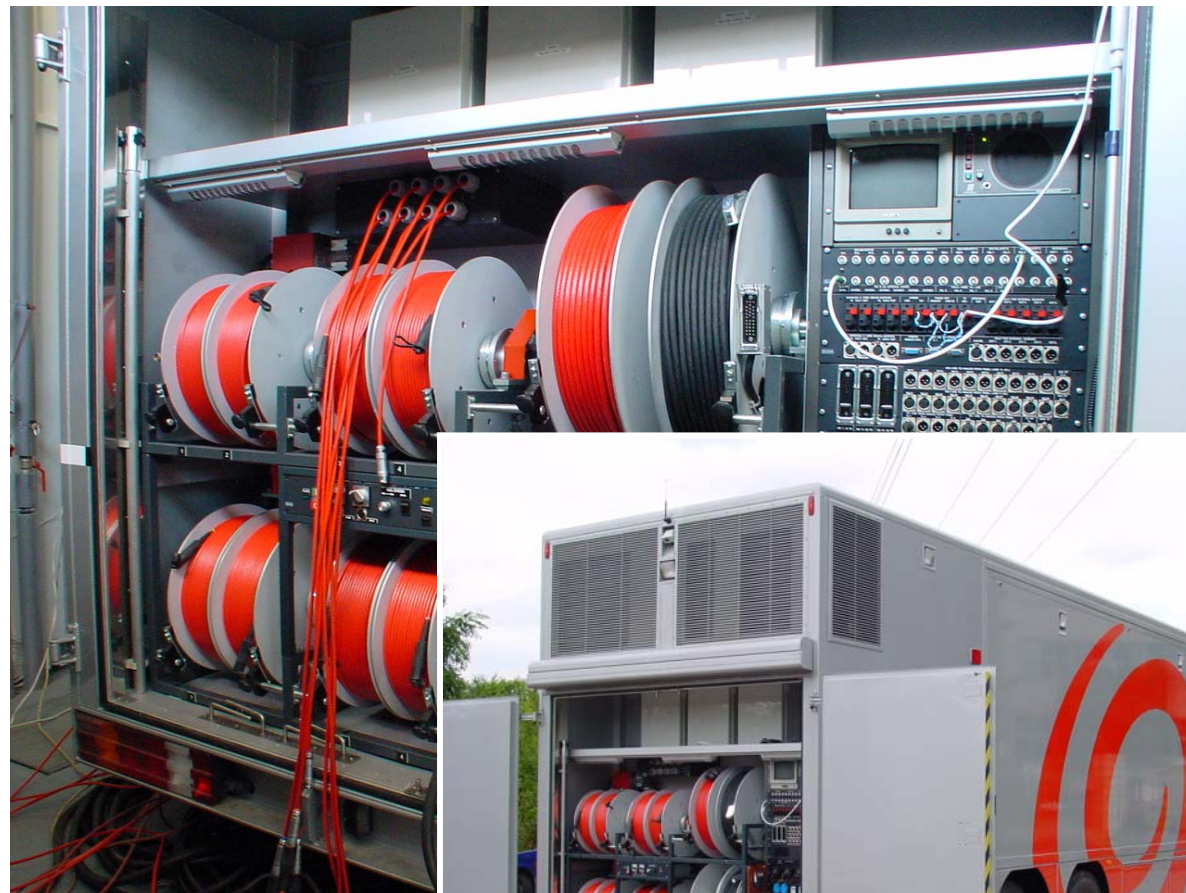

Digital 8-10 camera OB van

Production area:

- 25 monitor wall configured from matrix
- Programable under-monitor displays



- Production desk with video switcher, DME and character generator control
- Second row desk for slo-mo control and assistant
- Intercom panels and phone set

Digital 8-10 camera OB van

Audio area:

- 24 inputs audio mixer stereo
- Local audio sources – DAT, MD, CC, CD, instant replay



- Audio processor, limiter/expander, digital telephone hybrid
- Dual channel audio matrix 32x16, extensive patch panel
- Intercom, switchable monitors

Digital 8-10 camera OB van

Vision area:

- 8 camera control units and MSU
- SDI and PAL video matrix 32x16
- Dual SPG, WFM, 9 and 14" monitors



- Four Digital Betacam VTRs, dual channel digital disk recorder
- Slo-mo controllers

Digital 4-6 camera OB van

Application summary:

- Mid-sized unit, based on a MB Atego 1223 chassis
- Ideal for general-purpose productions as sports, Light entertainment, etc. Ideal for locations with limited space
- Featured equipment includes Sony BVP-950 cameras, Digital Betacam VTRs, the DVS-7200 switcher processor with DME-3000 digital multi-effects. The sound and communications facilities include a range of Senheisser microphones, an analogue audio mixer Studer; audio sources, telephone hybrid and talkback facilities



[illegible]

Vision area

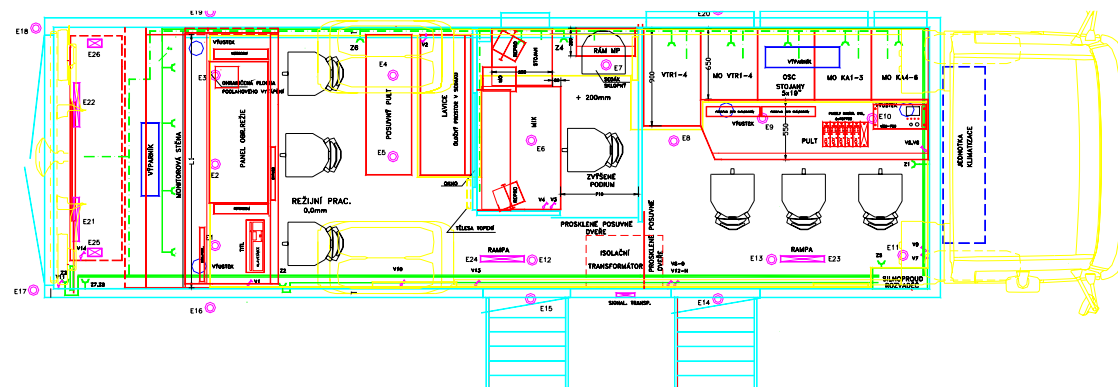

Digital 4-6 camera OB van

Interior:

- Production area



- Sound area

- Vision area



Digital 3-4 camera OB van

Application summary:

- Compact unit, based on a MB Vario 814D chassis
- Ideal for general-purpose productions as News, document, records inserts for studio productions, etc.
- Featured equipment includes Sony DXC-D35 cameras, Digital Betacam VTRs, the DFS-700 switcher processor digital multi-effects. The sound and communications facilities include a range of Sennheiser microphones, an analogue audio mixer; audio sources, telephone hybrid and talkback facilities



Digital 3-4 camera OB van

Plan layout:

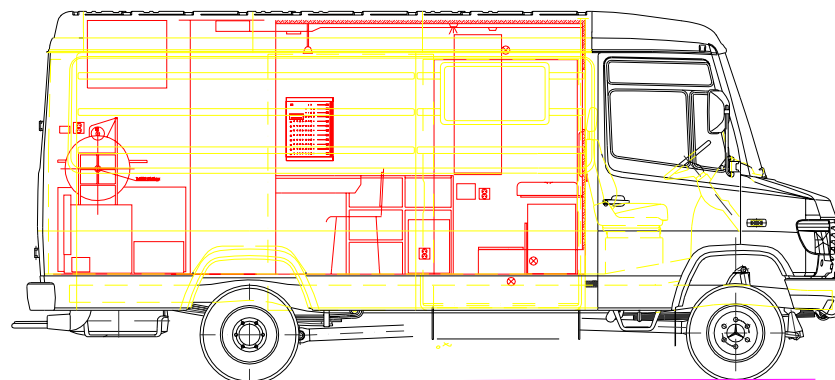

Rear cable area

Production area

Audio area

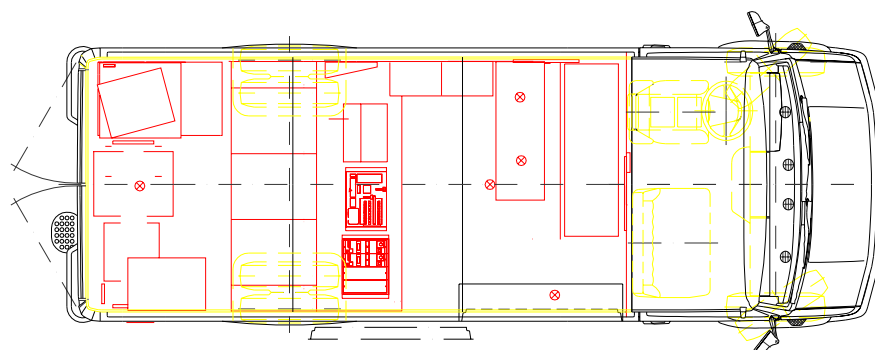



DSNG

Application summary:

- Small-sized unit, based on a MB Sprinter 416D 4x4
- Ideal for live news, sport and transmitting point for general-purpose production
- Featured equipment includes Sony DXC-D35 cameras, BetacamSX VTRs, the DFS-700 switcher processor with digital multi-effects, audio mixer etc.
- Encoder MPEG-2 4:2:2, 4:2:0, HPA 150W 13,75-14,5GHz, antenna 1,2m
- Panda generator 8kW
- Electromechanical system for automatic van nivelisation

DSNG

Plan layout:

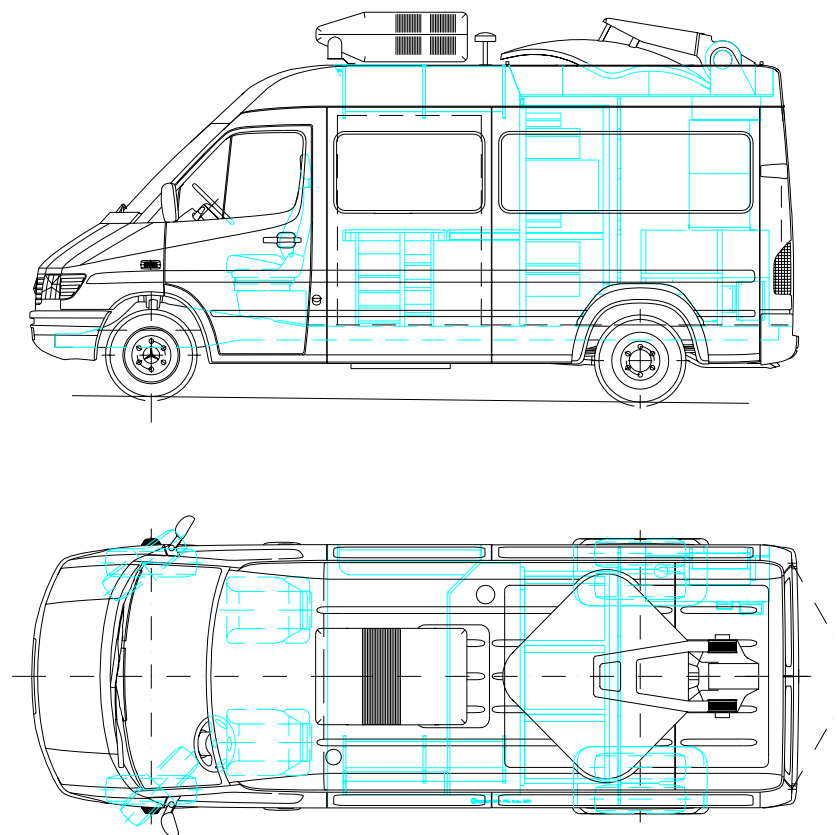

DSNG

Rear connection and storage area:

- 4 motorized cable drums
- PANDA generator 8kW
- Terminating panels for external connections



Vision area:

- Camera control unit
- Video and audio switcher
- BetacamSX, DVCAM VTRs
- Satellite equipment
- Measurement equipment



ENG

Application summary:

- Small-sized unit, based on a MB Sprinter 416D
- Ideal for transmitting point, receiving point, transmitting/receiving point of link
- Pneumatic telescopic mast 12m high
- Remote controlled Pan/Tilt head
- Microwave equipment
- Electromechanical system for automatic van nivelisation
- Panda diesel generator



ENG

Plan layout:

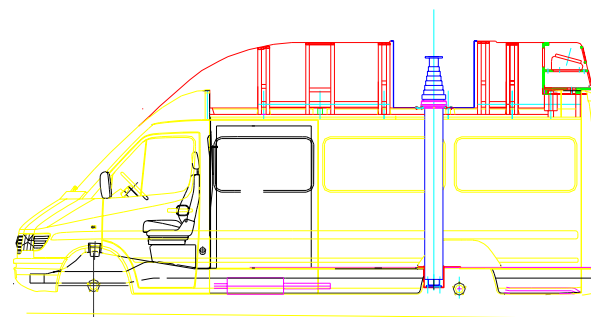
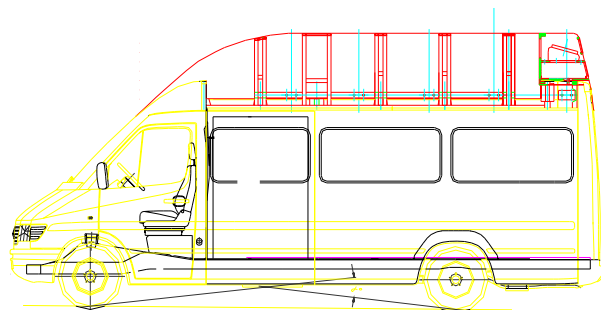
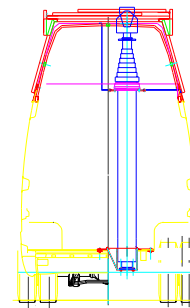
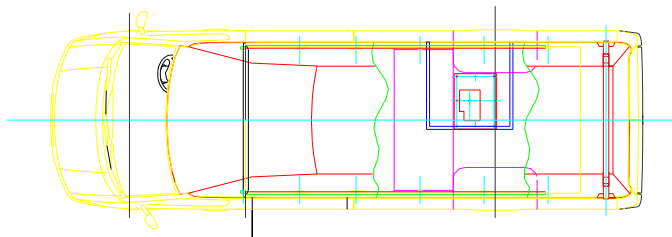

ENG

Interior:

- Video and audio monitors, WFM monitor
- Distribution amplifiers, router A+V, test generator, intercom etc.
- Microwave equipment



Rear ant top:

- Motorized cable drums
- Panda generator
- Telescopic Mast
- Pan/Tilt head with antenna

